



Mallard Crescent, Sittingbourne ME9 8TJ

Asking Price £290,000

A cosy home situated in the friendly village of Iwade, ideal for those looking for a property which is well presented and is a great opportunity ready for you to start off 2024 in style.

The well-proportioned layout includes a fitted kitchen, a recently decorated living room, a cloakroom, and a beautiful conservatory with bifold doors leading onto the low maintenance rear garden to the ground floor. To the first floor there are two double bedrooms with large fitted wardrobes and a family bathroom.

Externally the home comprises of parking at both the front and rear, a garage, and an enclosed, easily maintained garden with astro-turf.

Iwade Village offers a range of local shopping facilities, a primary school, a medical centre, and convenient access to the A249. Situated approximately 3 miles away, Sittingbourne town centre provides schools for all ages, high street shopping amenities, and a mainline railway station with high speed access to London.



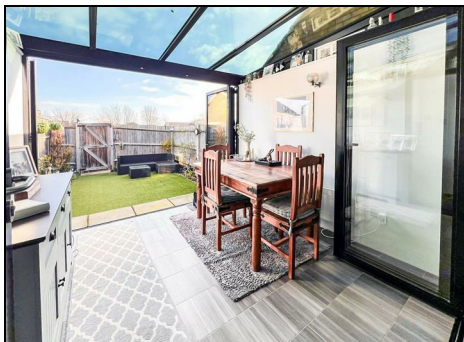
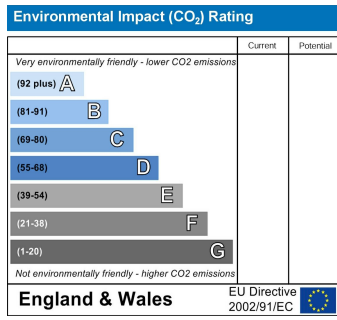
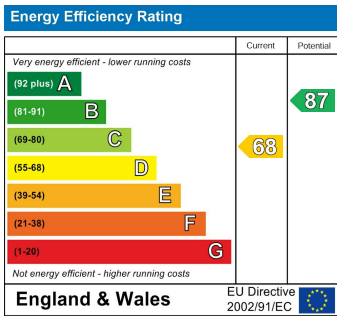

ESTATE AGENCY : REDEFINED

