



Windsor Road
Gillingham | ME7 4QN



Windsor Road
, Gillingham, ME7 4QN

Asking Price £165,000

OUR REAL ESTATE ARE DELIGHTED TO OFFER FOR SALE WITH NO ONWARD CHAIN THIS REFURBISHED TWO-BEDROOM FIRST FLOOR APARTMENT; CONVENIENTLY LOCATED WITHIN THE POPULAR RESIDENTIAL LOCATION OF GILLINGHAM.

THIS PROPERTY IS AN IDEAL FIRST-TIME BUY OR INVESTMENT OPPORTUNITY, AND HAS FANTASTIC POTENTIAL AND APPEAL WITH

- First Floor Apartment
- Two Double Bedrooms
- Recently Updated
- Private Garden
- Close To Town Centre & Station
- Ideal Investment Or First-time Buy
- Council Tax Band A

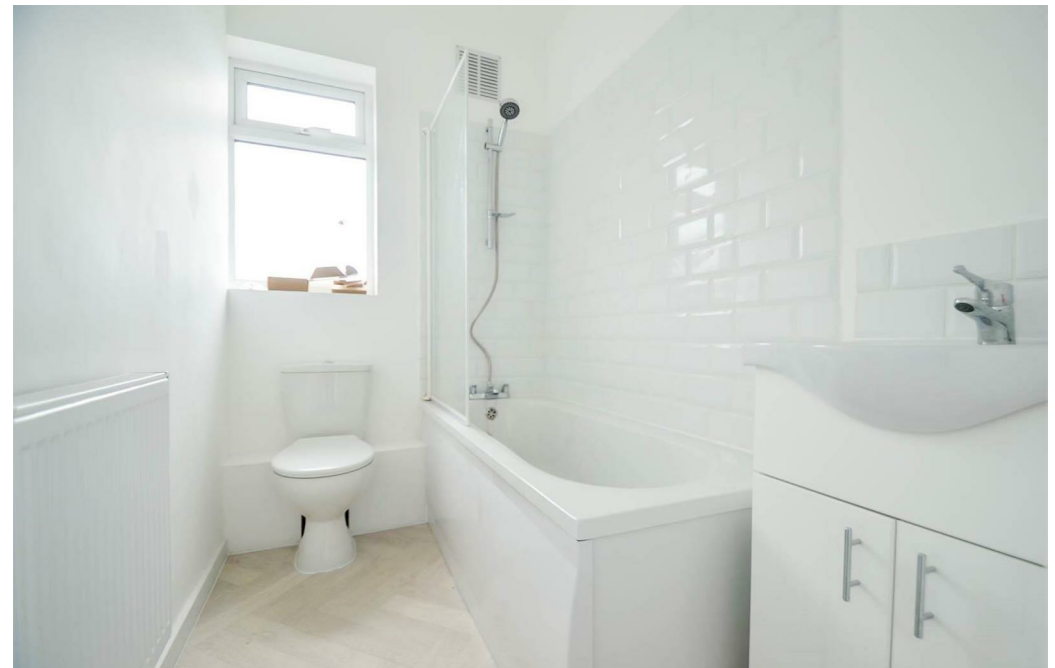

Lounge

11'7 x 10'7 (3.53m x 3.23m)

Bedroom

12'2 x 7'7 (3.71m x 2.31m)

Bedroom

10'4 x 8'6 (3.15m x 2.59m)

Kitchen

8'3 x 6'5 (2.51m x 1.96m)

Bedroom

7'3 x 4'6 (2.21m x 1.37m)

First Floor

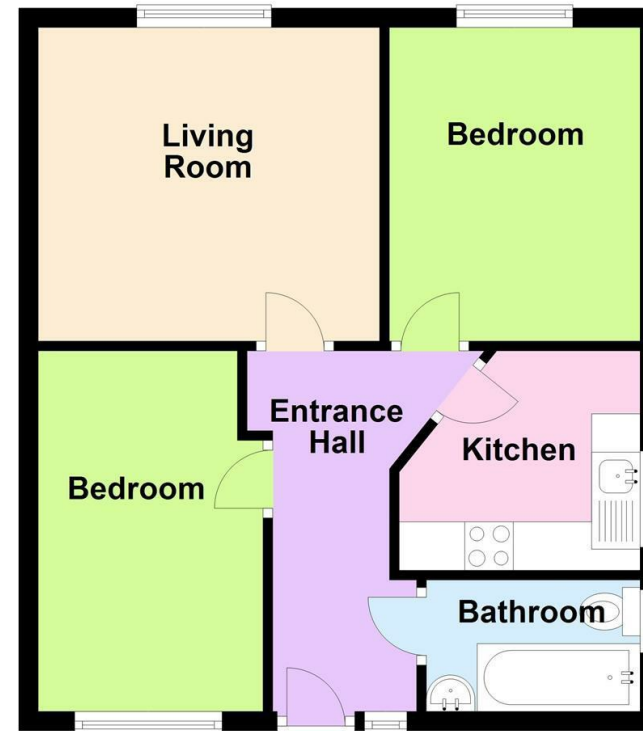



REAL ESTATE
ESTATE AGENCY · REDEFINED

18 - 20 High Street
Gillingham
Kent
ME7 1BB

01634 570057

www.crralestate.co.uk
twitter.com/CRRealEstateUK
facebook.com/CRRealEstateUK



rightmove
find your happy



ClientMoney
Protect



Energy Efficiency Rating		Current	Potential
Very energy efficient - lower running costs			
(92 plus) A			
(81-91) B			
(69-80) C			
(55-68) D			
(39-54) E		40	56
(21-38) F			
(1-20) G			
Not energy efficient - higher running costs			
England & Wales		EU Directive 2002/91/EC	

Environmental Impact (CO ₂) Rating		Current	Potential
Very environmentally friendly - lower CO ₂ emissions			
(92 plus) A			
(81-91) B			
(69-80) C			
(55-68) D			
(39-54) E			
(21-38) F			
(1-20) G			
Not environmentally friendly - higher CO ₂ emissions			
England & Wales		EU Directive 2002/91/EC	



CR Real Estate endeavour to maintain accurate depictions of properties in Virtual Tours, Floor Plans and descriptions, however, these are intended only as a guide and purchasers must satisfy themselves by personal inspection.